

PLAN DESCRIPTION (VD1925)	
OVERALL LENGTH:	58'-8"
OVERALL DEPTH:	62'-4"
SQUARE FOOTAGE:	
FIRST FLOOR LIVING AREA =	1,925 SQ. FT.
SECOND FLOOR LIVING AREA =	0
BONUS ROOM =	405 SQ. FT.
TOTAL SQ. FT. LIVING AREA =	1,925 SQ. FT.
GARAGE =	668 SQ. FT.
PORCH =	30 SQ. FT.
DECK =	180 SQ. FT.
BEDROOMS =	3
BATHS =	2 1/2
GARAGE =	2 CAR
BONUS ROOM =	YES
PRIMARY CEILING HEIGHT: 9'	
WALL CONSTRUCTION : 2"X4" FRAME W/ BRICK & STONE	
FOUNDATION TYPE: CRAWL SPACE	
PRIMARY ROOF PITCH: 10/12	

### FIRST FLOOR PLAN

LIVING AREA = 1,925 SQ. FT. (OUTSIDE OF BRICK)  
 GARAGE = 668 SQ. FT.

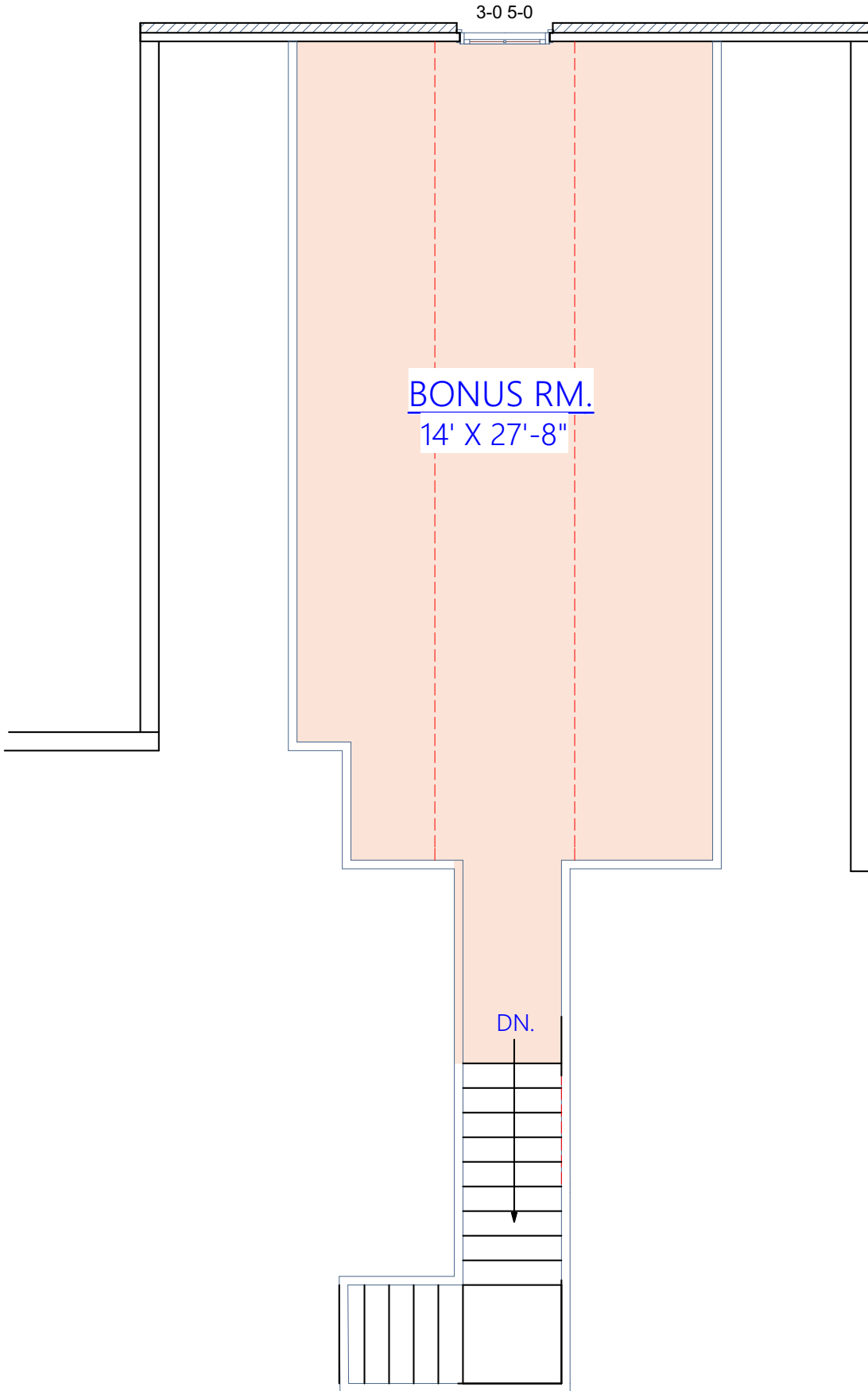

# SECOND FLOOR PLAN

BONUS ROOM = 405 SQ. FT.